



Vanity
BY DESIGN

Jack

Slimline

collection

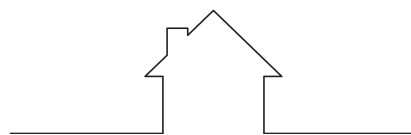

House Collection

Jack 900 Single - Coming Soon

Jack 1500 Double - Coming Soon

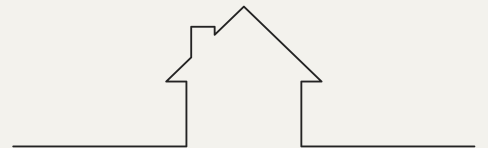

House Collection



Jack 900 Single



Jack 1500 Single

Cabinet Finish

Choose your Paint Finish | Custom Paint

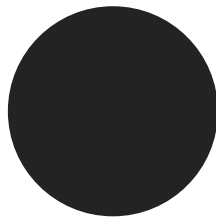

Black

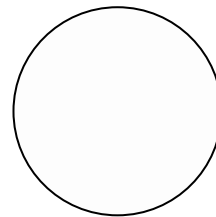

White

Bench Top

Subject to availability and chosen design



Snow-Blanc
Crystalline Silica-Free
(Engineered Stone)



Ayla
Crystalline Silica-Free
(Engineered Stone)



Jack Slimline collection

– Our Jack range is a contemporary design with slatted textural detail & seamless handle. Inspired by our *Mac vanity*, this slimline model allows customers to choose a stunning vanity for their small bathroom!

Jack 900 | Single Basin

900 Length x 360 Depth

Jack 1500 | Double Basin

1500 Length x 360 Depth

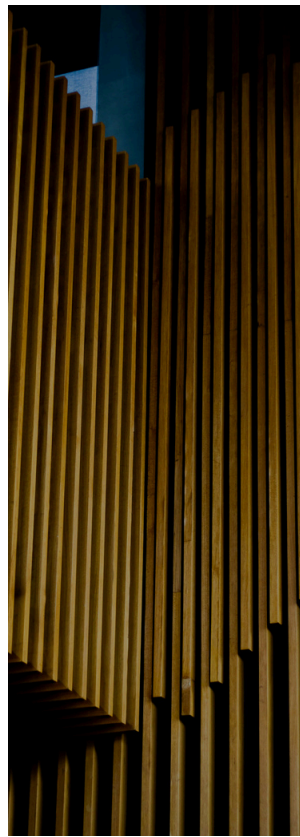

Jack

Jack 900 Slimline (Wall Hung)

Cabinet Size: 880mm (L) X 350mm (D) X 410mm (H)

Top Size: 900mm (L) X 360mm (D) X 20mm (H)

Type: Wall Hung

Basin: Client to nominate

No Tap Holes, Tapware to be wall-mounted

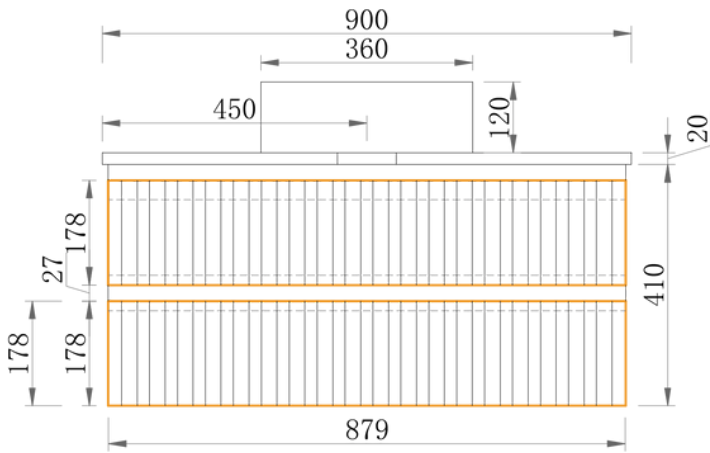
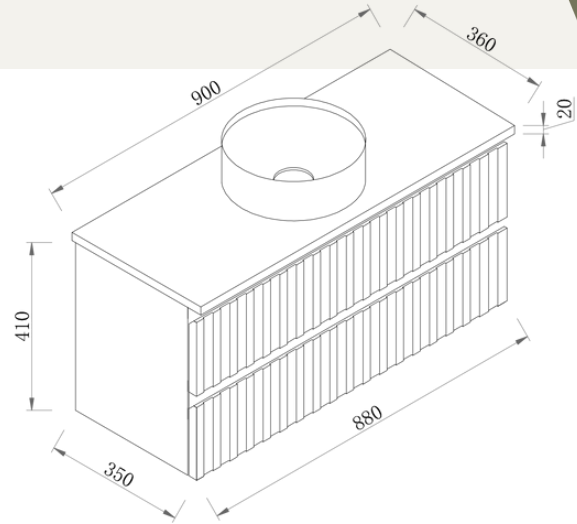

Front Elevation

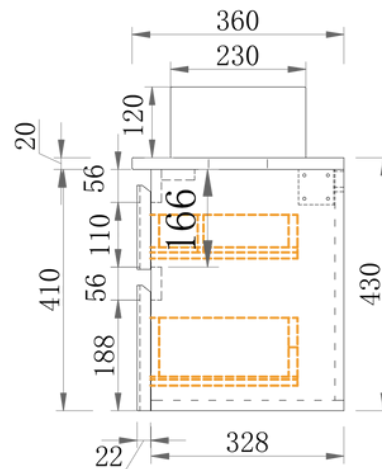

Section Side

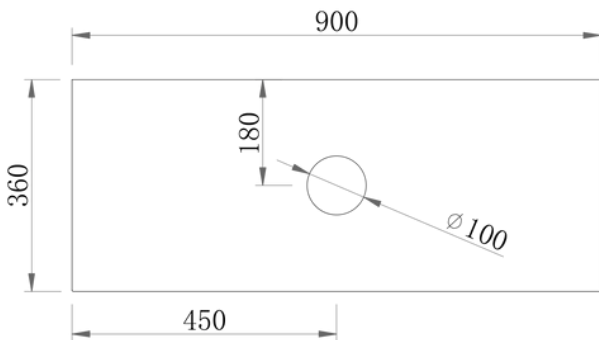

Top View

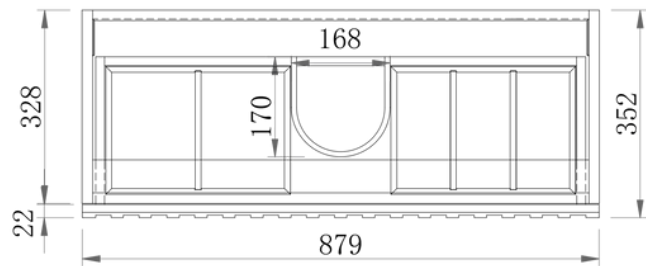

Section Top - Drawer Inserts

Notes:

- Wastes and faucets are not included.
- Vanity unit must be installed by a qualified tradesmen - Failure to do so will void the warranty.
- Plumbing fixtures must be installed by a qualified plumber - Failure to do so will void the warranty.
- Warranty information: 5 years on cabinet & 12 months on top and basin(s).
- Caution boxes may be heavy and will require 2 people to lift.



Jack

Jack 1500 Double Slimline (Wall Hung)

Cabinet Size: 1480mm (L) X 350mm (D) X 410mm (H)
 Top Size: 1500mm (L) X 360mm (D) X 20mm (H)
 Type: Wall Hung
 Basin: Client to nominate
 No Tap Holes, Tapware to be wall-mounted

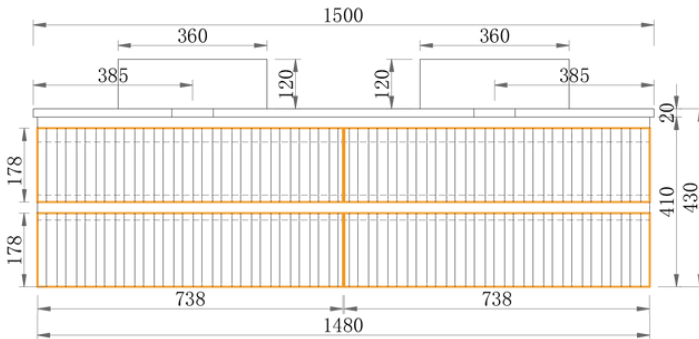
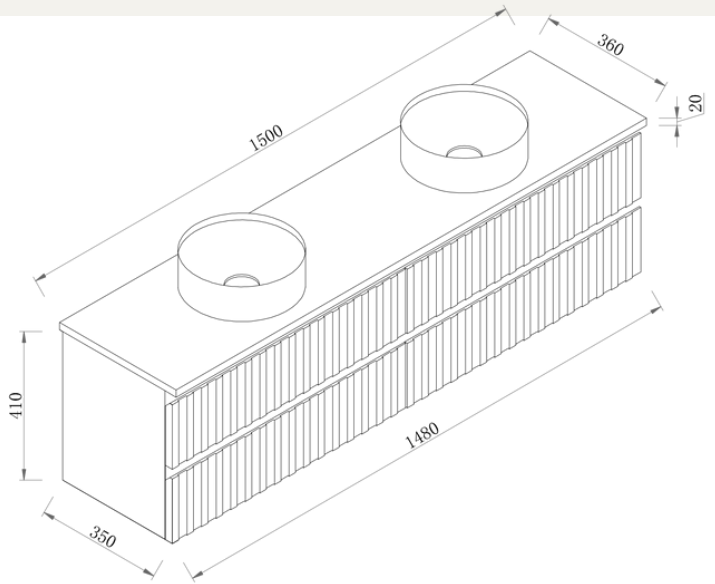

Front Elevation

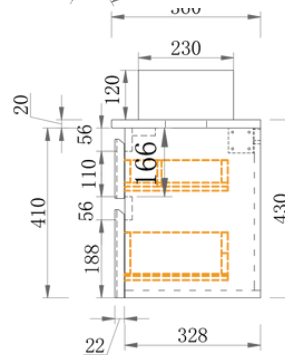

Section Side

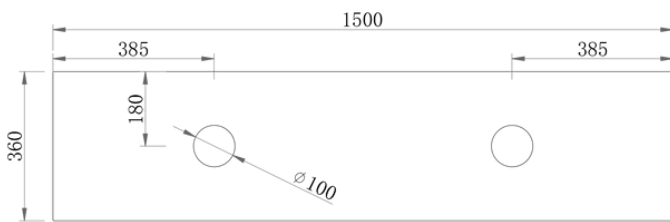

Top View

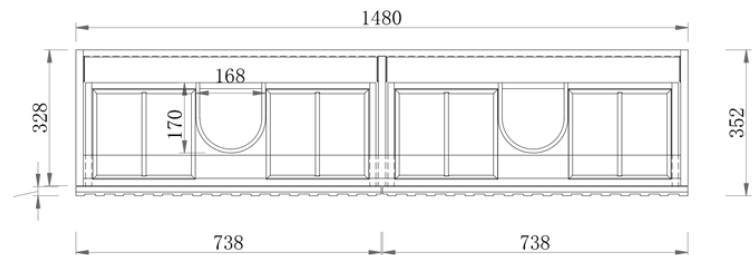

Section Top - Drawer Inserts

Notes:

- Wastes and faucets are not included.
- Vanity unit must be installed by a qualified tradesmen - Failure to do so will void the warranty.
- Plumbing fixtures must be installed by a qualified plumber - Failure to do so will void the warranty.
- Warranty information: 5 years on cabinet & 12 months on top and basin(s).
- Caution boxes may be heavy and will require 2 people to lift.



Vanity

BY DESIGN



vanitybydesign.com.au



[vanitybydesign_](https://www.instagram.com/vanitybydesign_)



TEL: 07 3376 6055



241 Monier Road
Darra, QLD, 4076